



10 Gadsden Close, Cranfield, MK43 0HF

Offers Over £300,000

Cranes





10 Gadsden Close

Bedford, MK43 0HF

- THREE BEDROOMS
- SINGLE GARAGE
- IMMACULATELY PRESENTED
- ENCLOSED GARDEN
- OFF ROAD PARKING
- DETACHED
- CUL-DE-SAC LOCATION
- CONSERVATORY
- LOUNGE

We are delighted to be instructed to sell this immaculately presented three bedroom detached property. Situated in a quiet cul-de-sac on the very edge of the village, the house comes with the added benefit of a single garage with double length driveway. The accommodation fully comprises of entrance hall, kitchen, lounge, conservatory/dining room, three bedrooms and a family bathroom. To the side of the house is a single garage with driveway providing off road parking and to the rear, a fully enclosed and well maintained rear garden with patio area. As the acting agents, we strongly recommend viewing to fully appreciate everything this wonderful home has to offer.



Offers Over £300,000



ENTRANCE HALL

KITCHEN 8'5" x 8'0" (2.586 x 2.445)

LOUNGE 14'11" x 13'9" (4.549 x 4.197)

CONSERVATORY/DINING ROOM
12'4" x 7'7" (3.76 x 2.33)

BEDROOM ONE 11'1" x 8'9" (3.38 x 2.669)

BEDROOM TWO 10'10" x 8'4" (3.321 x 2.558)

BEDROOM THREE 8'2" x 5'10" (2.496 x 1.787)

FAMILY BATHROOM 6'1" x 5'6" (1.875 x 1.677)





Floor Plans

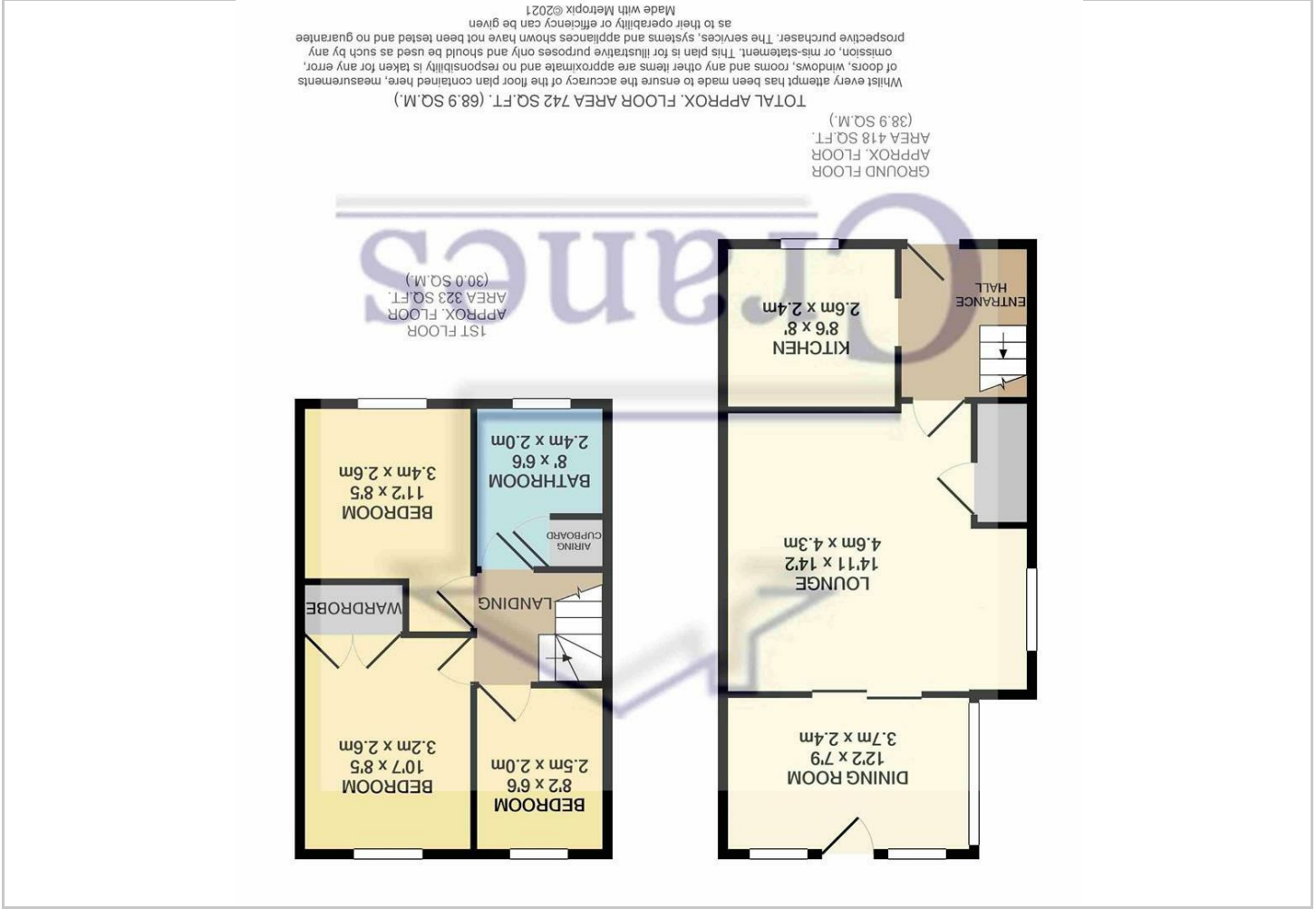

Viewing

Please contact our Cranes Estate Agents Office on 01234 750900
if you wish to arrange a viewing appointment for this property or require further information.

The particulars are set out as a general outline only for the guidance of intended purchasers or lessees, and do not constitute, any part of a contract. Nothing in these particulars shall be deemed to be a statement that the property is in good structural condition or otherwise nor that any of the services, appliances, equipment or facilities are in good working order. Purchasers should satisfy themselves prior to purchasing.

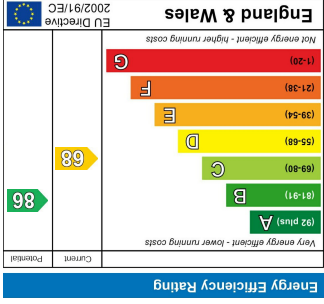

Energy Performance Graph

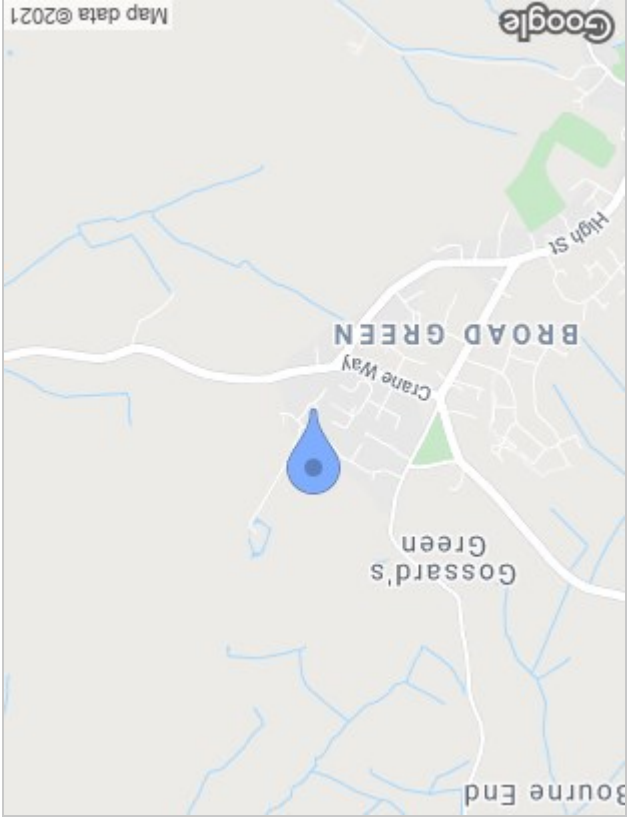

Location Map